



Greater Vancouver Regional District  
4330 Kingsway, Burnaby, British Columbia, Canada V5H 4G8

General  
Telephone (604) 432-6200  
Fax (604) 432-6251

Air Quality and Source Control Department - Tel (604) 436-6700 Fax (604) 436-6707

# PERMIT

(Under the provisions of the GVRD Air Quality Management Bylaw No. 725)

BEL-PAR INDUSTRIES LTD.

IS AUTHORIZED TO DISCHARGE AIR CONTAMINANTS  
FROM A STORE FIXTURES MANUFACTURING PLANT  
LOCATED AT 12160 - 103A AVENUE, SURREY, B.C. V3V 3G8

This permit has been issued under the terms and conditions  
prescribed in the attached Schedules A, B, C, D, E, F, G & H  
for emission sources and works existing or planned on November 30, 1992.

  
ASSISTANT AIR QUALITY DIRECTOR

PERMIT NUMBER GVA0253

**INDEX OF SCHEDULES**

Schedule A ..... Site Plan

Schedule B ..... General Requirements

Schedule C ..... Emission Monitoring, Sampling and Reporting Requirements

Schedule D ..... Emission Sources and Discharge Points

Schedule E ..... Authorized Rates of Discharge

Schedule F ..... Authorized Discharge Criteria

Schedule G ..... Authorized Works and Procedures

Schedule H ..... Record of Permit Issuance Dates



# Greater Vancouver Regional District

4330 KINGSWAY, BURNABY, BRITISH COLUMBIA, V5H 4G8 TELEPHONE 436-6700

## GVRD Air Quality Management Bylaw No.725

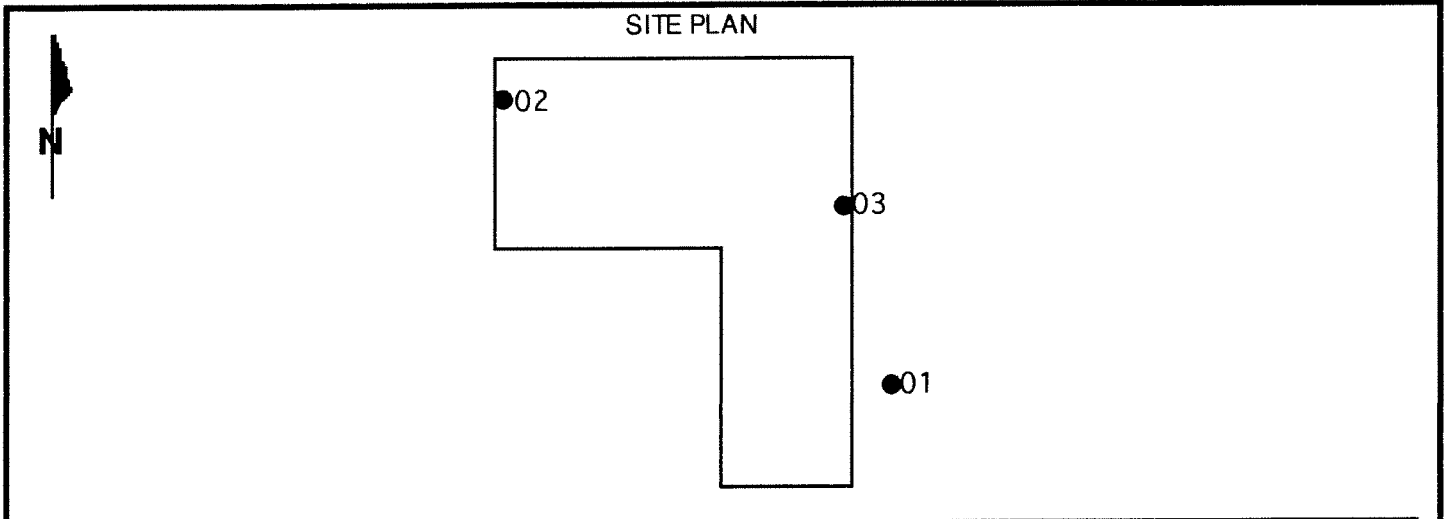

103 A AVENUE

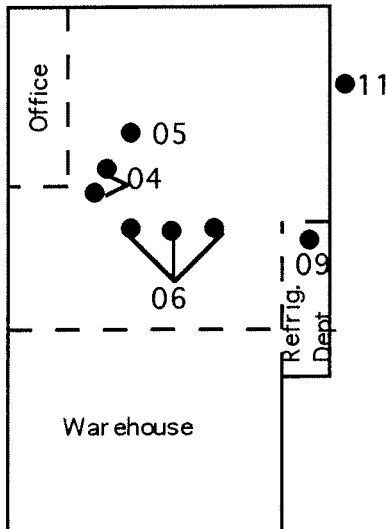

THE NUMBERED LOCATIONS OF THE DISCHARGE POINTS ARE APPROXIMATE N.T.S.

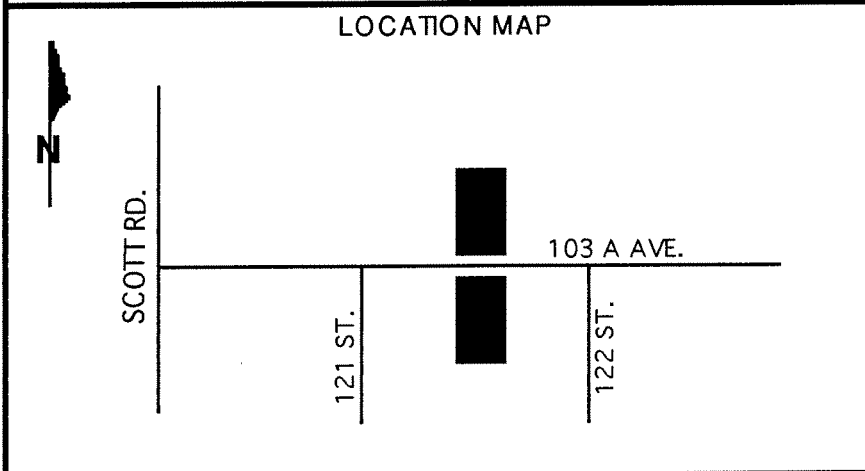

NOV 30 1992

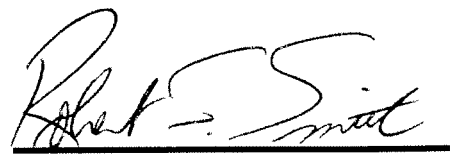

Assistant Air Quality Director

Schedule A to Permit No. GVA0253

SCHEDULE B - PAGE 1  
to PERMIT GVA0253

A. OBJECTIVES AND AMENDMENTS

Ambient air quality guidelines and objectives are prescribed under provisions of applicable legislation. If the level of air quality as prescribed by these criteria is exceeded, the conditions of this Permit may be revised, in order that the desired air quality can be maintained. This Permit may also be amended for other reasons, as authorized by applicable legislation.

B. MAINTENANCE AND OPERATION OF WORKS

Works and procedures, which this Permit authorizes to control the discharge of air contaminants, shall be employed during all operating periods of the related facilities. The Permittee shall regularly inspect and maintain all such works in good repair.

C. EMERGENCY PROCEDURES

An emergency or other condition may prevent the continuous utilization of the above authorized works and procedures, or may result in a discharge of air contaminants which is not authorized by this Permit. If such a situation occurs, the Permittee shall report the circumstances of this event to the Greater Vancouver Regional District, Air Quality and Source Control Department at 436-6777 (24 hours), at the first available opportunity.

No discharge that has bypassed control works is authorized unless the Air Quality Director's approval has been obtained. In the event of an emergency, bypassing facilities may be used for such periods as are necessary to effect a shutdown of the related processes.

D. AIR CONDITIONING, HEATING AND VENTILATION SYSTEMS

Air contaminants discharged from any natural gas-fired air conditioning, heating or ventilation systems for buildings located at the discharge site are not specified in this Permit. These works shall be maintained and operated in a manner prescribed by the manufacturer to ensure good combustion of the fuel with minimum discharge of air contaminants. Notwithstanding the above, the Air Quality Director may at his discretion stipulate limits for emission of contaminants from these sources in the Permit at a future date under provisions of the Bylaw.

November 30, 1992

  
ASSISTANT AIR QUALITY DIRECTOR

SCHEDULE B - PAGE 2  
to PERMIT GVA0253

## E. GENERAL SITE RESTRICTIONS

No air contaminant(s) from any single source, or combination of sources shall pass the boundary of the property, described in Section H of this Schedule B, such that the Air Quality Director determines that air pollution has occurred.

## F. ENGINEERING UNITS

The engineering units specified in this Permit are in accordance with the Metric System of measure. Approximate equivalent values for the British System can be calculated using the following conversion factors.

$\text{mg/m}^3 \times 0.000437$	=	gr/cf
$\text{m}^3/\text{min} \times 35.3$	=	cf/min
$\text{kg/m}^3 \times 0.0624$	=	lbs/cf
$\text{kg/L} \times 10.0$	=	lbs/gal
$\text{mg/m}^3 \times 24.0/\text{M}$	=	ppm (by volume)

where

$\text{m}^3$	=	cubic metre	min	=	minute
mg	=	milligram	cf	=	cubic feet
s	=	second	lb	=	pound
kg	=	kilogram	gal	=	gallon
L	=	litre	M	=	molecular weight
gr	=	grain	ppm	=	parts per million

November 30, 1992

  
 ASSISTANT AIR QUALITY DIRECTOR

SCHEDULE B - PAGE 3  
to PERMIT GVA0253

G. STANDARD CONDITIONS AND DEFINITIONS

Except where otherwise indicated, the following standard conditions and definitions apply to this Permit.

1. The Restrictions in the attached Schedules are maximum limits.
2. Gaseous volumes are corrected to dry conditions of 20° Celsius & 760mm Hg.
3. Particulate matter from combustion sources is corrected to 12% Carbon Dioxide.
4. Opacity is measured at the point of maximum density, nearest the discharge point.
5. Opacity measurements exclude the effect of condensed, uncombined water droplets.
6. Definitions in the Waste Management Act and GVRD Air Quality Management Bylaw No. 725 apply to terminology used in this Permit.
7. Threshold Limit Values (TLV) refer to the Time Weighted Average (TWA) exposure limits for substances specified in the American Conference of Governmental Industrial Hygienists Threshold Limit Values handbook for the years 1991 - 1992.
8. Any production, storage, transportation, handling, treatment, processing or ownership of a special waste must comply with the requirements of the Waste Management Act, Special Waste Regulation.

H. DESCRIPTION OF DISCHARGE SITE

The land from which the air contaminants are discharged is described as "District of Surrey Lot 43 Section 30 Block 5 North Range 2 West New Westminster District Plan 31041."

November 30, 1992

  
ASSISTANT AIR QUALITY DIRECTOR

SCHEDULE C - PAGE 1  
to PERMIT GVA0253

This Schedule describes emission monitoring, sampling and reporting requirements.

The Permittee shall conduct the following monitoring and sampling program on the discharges and submit the results to the Air Quality Director. The need for increased or decreased monitoring may be reviewed periodically by the Air Quality Director.

<b>EMISSION NUMBER</b>	<b>DUE DATE(S)</b>	<b>REQUIREMENT(S)</b>
General	March 31, 1993 and annually thereafter	Written report detailing the types and amounts of principal products produced and principal raw materials used in the preceding calendar year.
General	March 31, 1993 and annually thereafter	Written report detailing the types and amounts of fuel burned in the preceding calendar year.
General	March 31, 1993 and annually thereafter	Written report detailing the types, amounts and end use of organic solvents and organic solvent-containing materials used in the preceding calendar year.
General	March 31, 1993 and annually thereafter	Written report detailing the total number of hours and days operated during the preceding calendar year. Records are to be maintained in a written bound log or other format approved by the Air Quality Director, and made available for inspection, by Air Quality and Source Control staff for a minimum period of three years.

Emission testing and ambient air sampling and monitoring, shall be undertaken by the Permittee when required by the Air Quality Director.

November 30, 1992

  
ASSISTANT AIR QUALITY DIRECTOR

SCHEDULE D - PAGE 1  
to PERMIT GVA0253

The authorized emission sources and discharge points located approximately as shown on Schedule A are:

EMISSION NUMBER	EMISSION SOURCE	DISCHARGE POINT
01	Ventilation of woodworking equipment and 1 arborite glue layup machine in the wood fabricating plant	Cyclone exhaust
02	West paint spray booth in the woodworking shop	Stack
03	East paint spray booth in the woodworking shop	Stack
04	Paint spray booth in the metal department	Two stacks
05	Bake oven in the metal department	Stack
06	Ventilation of 2 wash tanks and 1 tank heater in the metal department	Three stacks
09	Ventilating of the polyurethane panel for ming area	Roof exhaust
11	Metal shop ventilation system	Wall exhaust

November 30, 1992

  
ASSISTANT AIR QUALITY DIRECTOR



SCHEDULE E - PAGE 1  
to PERMIT GVA0253

The authorized rates of discharge for the emission sources described in Schedule D are:

EMISSION NUMBER	MAXIMUM AUTHORIZED RATE OF DISCHARGE			NOTES & ADDITIONAL REQUIREMENTS
	FLOW m <sup>3</sup> /min	DURATION hours/day	FREQUENCY days/week	
01	435	15	5	Maximum 2400 hours/year.
02	283	15	5	Maximum 2325 hours/year.
03	198	7.5	5	Maximum 112 hours/year.
04	980	15	5	Maximum 2550 hours/year.
05	354	14	5	Maximum 2520 hours/year.
06	102	7	5	Maximum 1260 hours/year.
09	198	15	5	Maximum 2550 hours/year.
11	34	15	5	Maximum 2325 hours/year.

November 30, 1992

  
ASSISTANT AIR QUALITY DIRECTOR

SCHEDULE F - PAGE 1  
to PERMIT GVA0253

The authorized maximum discharge criteria for emission sources described in Schedule D are:

EMISSION NUMBER	PARAMETER	RESTRICTION	NOTES
01 - 05	Chemical Contaminants	See notes	The maximum allowable emission concentration (EC) for each emitted chemical contaminant with a Threshold Limit Value (TLV) is such that the sum of the individual EC/TLV ratios for all such contaminants is less than 10.
05	Combustion Products	See notes	Typical products of natural gas combustion at a maximum firing rate of 1.6 MM Btu/hr.
06	Combustion Products	See notes	Typical products of natural gas combustion at a maximum firing rate of 0.8 MM Btu/hr.
01 - 09	Odour	See notes	None past the plant boundary such that the Air Quality Director determines that air pollution has occurred.
01 & 11	Opacity	20 percent	May be exceeded for a total of 3 min/hour
11	Particulate matter	50 mg/m <sup>3</sup>	
01	Particulate matter	120 mg/m <sup>3</sup>	
09	Toluene-2, 4-diisocyanate	0.4 mg/m <sup>3</sup>	

November 30, 1992

  
ASSISTANT AIR QUALITY DIRECTOR

~~~~~  
**SCHEDULE G - PAGE 1  
to PERMIT GVA0253**

The authorized works and procedures to control the discharge of air contaminants from the emission sources described in Schedule D are indicated below. The Air Quality Director may require that further works be installed, if the existing works, in his opinion, do not provide an acceptable level of emission control. New works or alterations to existing works must be approved, in principle, by the Air Quality Director.

Where the Air Quality Director has specified that additional works are required, the maximum discharge criteria described in Schedule F of this Permit are applicable as specified by the Completion Date(s) listed below. Prior to the specified date(s) the existing control works and procedures must be maintained in good operating condition and operated in a manner to minimize emissions.

| <b>EMISSION NUMBER</b> | <b>COMPLETION DATE</b> | <b>DESCRIPTION OF WORKS/PROCEDURES</b>                                                              |
|------------------------|------------------------|-----------------------------------------------------------------------------------------------------|
| 01                     | Completed              | Cyclone and related appurtenances together with good operating practices.                           |
| 02                     | Completed              | Dry filters and related appurtenances together with good operating practices.                       |
| 03 & 04                | Completed              | Waterwall filter and related appurtenances.                                                         |
| 05, 09 & 11            | Completed              | Good operating practices.                                                                           |
| 06                     | Completed              | The firing of the heater with natural gas using good combustion practices and operating procedures. |

November 30, 1992

  
ASSISTANT AIR QUALITY DIRECTOR

SCHEDULE H - PAGE 1  
to PERMIT GVA0253

RECORD OF PERMIT ISSUANCE

| DATE              | ACTION   | SECTIONS AFFECTED                       |
|-------------------|----------|-----------------------------------------|
| November 30, 1992 | Issuance | Face, Schedules A, B, C, D, E, F, G & H |

November 30, 1992

  
ASSISTANT AIR QUALITY DIRECTOR